

1st Newsletter

COPA DEL MÓN D'ESLÒL OM

#canoelaseu



DEL 10 al 12 de JUNY
LA SEU D'URCELL



<http://canoeslalomseu.parcolimpic.cat>



Federació Catalana de
PIRAGÜISME



Los 16
de BRASIL 2016

Contents



1st NEWSLETTER (March 2016)

TABLE OF CONTENTS	Page
RFEP Invitation	3
Facts about La Seu d'Urgell	4
Parc Olímpic del Segre venue	5
How to get to La Seu d'Urgell	6
Airports to get to La Seu d'Urgell	7
Canoe Slalom Cluster in the Pyrenees	8
Venue Maps	9
Organizing Committee	10
Provisional Competition Programme	11
White Water Slalom Cross: a new official competition	12
Entries and key dates for team leaders	13
Accreditation and participation fee	14
Accommodations, press and media information	15
Information from the organizer	16
Contacts	17

Greetings from the President of the Royal Spanish Canoe Federation



Dear President,
Dear Secretary General,

La Seu d'Urgell will host in Parc Olímpic del Segre the 2nd Slalom World Cup **from 6 to 12 June** 2016. On behalf of the Organizing Committee I express our gratitude to International Canoe Federation for selecting again this venue, to host the canoe slalom teams and the media partners. We shall work to fulfill our responsibilities and we will help in your stay with dedication to a nice and fair sport competition.

The Royal Spanish Canoe Federation invites the athletes and canoe teams to attend the ICF Slalom World Cup in La Seu d'Urgell. This First Newsletter will help to inform concerning the event and the travel and hospitality issues. For specific information please contact to the canoeslalomseu@parcolimpic.cat

I look forward to see you soon,



Juan José Román Mangas
President of the Royal Spanish Canoe Federation
President of Organizing Committee

Facts about La Seu d'Urgell



The historic city of La Seu d'Urgell, on the Catalan Pyrenees, has a tradition of over 40 years organizing white water canoe competition events. The Olympic games of Barcelona 1992 was a landmark on this support of canoe slalom.

Later those memorable days that permitted slalom to be accepted on the Olympic programme, fifteen World Cup events and the World Championships 1999 and 2009 endorse the facilities on Parc Olímpic del Segre and the organizing team.

The **2016 Canoe Slalom World Cup, to be held from 10th to 12th of June**, is a new opportunity to give service to the slalom canoe family.

The challenge aims to improve technology on sport competitions, presence on media (especially TV), and worldwide promotion of canoe slalom through the participation over 40 national teams, and attract tourism in La Seu d'Urgell. The history on the old town, the mountain valley around Cadí-Moixeró Natural Park, and the local dedication to sport should be known.

In addition this occasion will keep active and financially healthy the Olympic facility of Park del Segre.

The World Cup are possible thanks to the support of institutions and sponsorships. On behalf of the organizing Committee we thank their help.

We trust on the contribution of the participant teams and we are ready to work for a fair competition and a happy stay in our country.

On behalf of ICF, RFEP, FCP and the Organizing Committee,

Welcome to the 2016 Canoe Slalom World Cup.

Parc Olímpic del Segre venue

The Parc Olímpic del Segre is constructed in a branch of the Segre river, which was re-channelled after the damage caused by the exceptional flood of 1982. The slalom course's specific features are as follows:

- Length: 300 m
- Drop: 6,5 m
- Flow: 12 m³/s
- Course features: concrete bottom, banks and obstacles of natural boulders
- Spectators capacity: 5.000 people

The Competition Course is accompanied by a beginners course which is 130 m long with a drop of 1,5 m. The designed flow ranges from 3 to 10 m³/s.

The design of the white water canals includes a system of complementary canals and mechanical conveyor belts which enable canoeists to return to their starting point without having to leave their boats. The dynamic conception of the whole facilities leads to intensive use all year round and separation of paddlers according to their levels of skill and ability.

The drop in the Slalom course is created naturally via channels that branch from the Segre river, with a very gentle slope. The feeder canal, 185 m in length, and mainly the flat water canal, 650 m in length and 20 m in width, are set aside for training in flat water canoeing and the necessary practice that sport lovers require in waters with a steady current.



How to get to La Seu d'Urgell



La Seu d'Urgell is placed at 10 km of Andorra and 180 km of Barcelona

GPS: Latitude 42,22N / Longitude 1,28E

HOW TO GET HERE:

BARCELONA AIRPORT Novatel (Barcelona Airport - Andorra)

It's necessary to book the ticket. <http://www.andorrabybus.com>

Tel. (+376) 803789

E-mail: novatel@andorrabybus.com

Timetables: Airport – Andorra: 10:00h – 12:00h – 14:00h – 16:00h – 18:00h - 20:00h – 22:00h
Andorra – Airport: 5:00h – 9:00h – 11:00h – 13h00 – 15:00h - 17:00h

TOULOUSE AIRPORT Novatel (Gare Matabiau – Andorra)

It's necessary to book the ticket. <http://www.andorrabybus.com>

Tel. (+376) 803789

E-mail: novatel@andorrabybus.com

Timetables: Gare Matabiau – Andorra: 10:30h 15:00h – 19 30h
Andorra – Gare Matabiau: 5:00h – 10:00h 15:00h

GIRONA AIRPORT Novatel (Girona Airport – Andorra- Girona Airport)

It's necessary to book the ticket. <http://www.andorrabybus.com>

Tel. (+376) 803789

E-mail: novatel@andorrabybus.com

Timetables: Girona Airport – Andorra: 20:00 h
Andorra – Girona Airport: 15:00 h

BARCELONA (CITY) Barcelona Bus Station (Estació del Nord) – La Seu d'Urgell

Alsina Graells <http://www.alsa.es>

Tel. (+34) 902 422242

Timetables: Barcelona – La Seu d'Urgell: 6h30 - 7h00 - 7h30- 10h30 - 13h00 - 15:00h – 19:00h
La Seu d'Urgell – Barcelona: 5h30 - 6h15 - 6h30 - 11h30 - 15h30 - 16h30 - 19h45

LLEIDA Lleida (Bus Station) – La Seu d'Urgell

Alsina Graells <http://www.alsa.es>

Tel. (+34) 902 422242

Timetables Lleida – La Seu d'Urgell: 8h45 -16h15 -19h30
La Seu d'Urgell – Lleida: 6:00 h - 6h15 - 15h45 - 16h30

Airports to get to La Seu d'Urgell



AIRPORT DESCRIPTION

Airport Andorra - La Seu d'Urgell 10 km 5 min

Three international airports available in Spain:

- ✓ Barcelona (BCN) 190 Km 2h15min
- ✓ Girona-Barcelona (GRO) 220 Km 2h30min
- ✓ Alguaire-Lleida 140 Km 2h

Two airports available in France:

- ✓ Toulouse-Blagnac 210 Km 3h
- ✓ Perpignan Airport 150 Km 2h

ROADS TO THE VENUE/CITY

LA SEU: Highway A2 Barcelona – Lleida, Road C-14: Cervera, Ponts, la Seu d'Urgell.

RAIL NETWORK

LA SEU: The rail network does not reach La Seu. But La Seu can be reached by taking the train from Barcelona to Puigcerdá followed by a bus to La Seu (Alsa – Alsina Graells).

Canoe Slalom Cluster in the Pyrenees



Distance from La Seu d'Urgell to:

Arfa	4 km	5 min
Ponts	60 km	50 min
Sort	46 km	1 h
Foix	120 km	2 h
Pau	280 km	4 h

ARFA - 4 kms (Segre River)



PONTS - 60 kms (Segre River)



Venue MAPS

1. OFFICIALS AREAS
2. COMPETITION VENUE
3. TEAMS AREAS
4. MEDICAL FACILITIES
5. MEDIA AREAS
6. OFFICES AREA
7. VIP AREAS
8. SPECIAL HOSTING AREAS

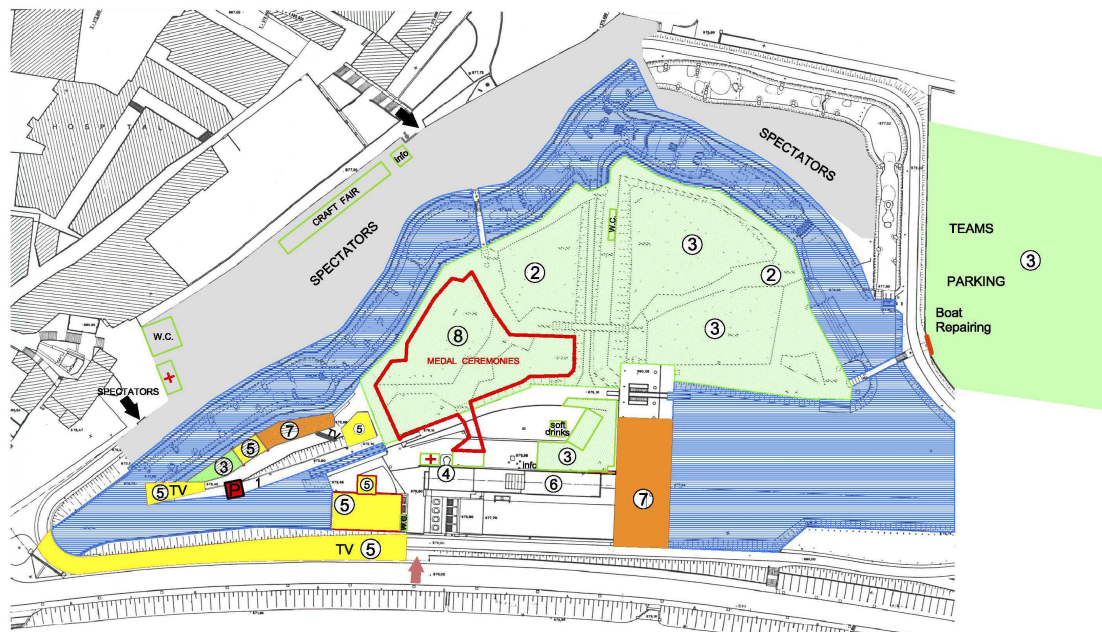

	EL PROYECTO: RAMON GANYET SOLÉ Enginyer de Comins. C. i. P. rganyet@parcsegre.es 25700 LA SEU D'URGELL	EL INGENIERO: RAMON GANYET SOLÉ	NORTE: ARCHIVO: Distribución de espacios y accesos ESCALA: 1:1000 FECHA: JUNIO 2016 ESCALA GRÁFICA: 0 5 10 15 20 25 50	PROYECTO: INFRAESTRUCTURAS DEL PARQUE OLÍMPICO PLANO: AREA DE COMPETICIÓN. PLANTA GENERAL PLANO Nº: 1 1 DE 1
--	--	--	---	--

CANOE SLALOM WORLD CUP LA SEU D'URGELL 10 - 12 JUNE 2016

- PUNTO DE CONCENTRACION
- SALIDA DE EMERGENCIA
- EVACUACION

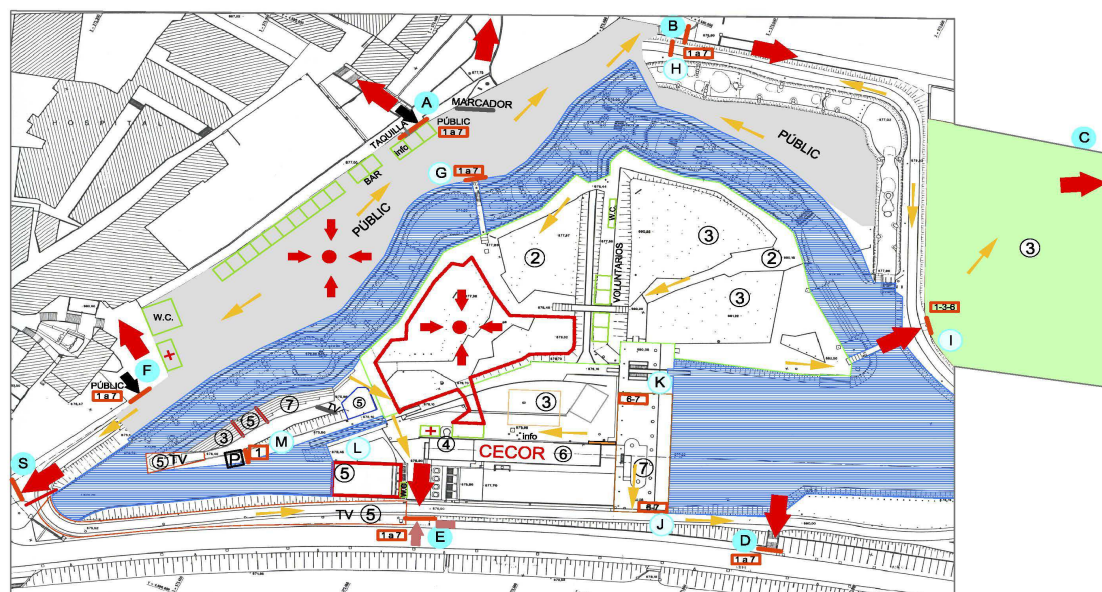

	EL PROYECTO: RAMON GANYET SOLÉ Enginyer de Comins. C. i. P. rganyet@parcsegre.es 25700 LA SEU D'URGELL	EL INGENIERO: RAMON GANYET SOLÉ	NORTE: ARCHIVO: Emergencias ESCALA: 1:1000 FECHA: ESCALA GRÁFICA: 0 5 10 15 20 25 50	PROYECTO: INFRAESTRUCTURAS DEL PARQUE OLÍMPICO PLANO: PLANO DE EMERGENCIA Y EVACUACION PLANO Nº: 3 1 DE 1
--	--	--	---	---

Organizing Committee



Sr. D. Juan José Román Mangas
RFEP President and Organizing Committee Chairman

Sra. D^a Ana Muñoz Merino
Sports Director of Spanish Sports Council

Sr.D. Gerard Figueras Albá
Secretary General of Sports of Generalitat de Catalunya

Sr. D. Albert Batalla Siscart
Mayor of La Seu d'Urgell

Sr. D. Joan Reñé Huguet
President of Lleida provincial Council

Sr. D. Joan Ignasi Rosell Urrutia
President of Catalan Canoe Federation

Sr. D. Jean Michel Prono
Chairman of ICF Canoe Slalom Committee

Sr. D. Ramon Ganyet Solé
Manager Director of Organizing Committee

Sr. D. Enric Balastegui Artigues
Presidente of CADí Canoe Kayak club

Sra. D^a. Núria Vilarrubla Cortina
Secretary General of Organizing Committee

Sr. D. Francesc Ganyet Solé
Manager of Parc Olímpic del Segre

Provisional competition programme



6 to 9 June		Official training by groups
Wednesday, 8th	11:00 h	Team leaders meeting
Thursday, 9th	16:00 h 17:30 h 18:00 h 20:00 h	Self-service check in boat and equipment Finals demonstration run Technical Officials meeting Heats demonstration run and Technical rehearsal Opening ceremony
Friday, 10th	9:00 - 19:10 h	Heats: C-1 M, C-1 W, K-1 M, K1-1 W and C-2 M
Saturday, 11th	9:00 - 12:10 h 12:30 - 14:00 h 15:15 h 16:30 - 18:30 h	Semi-final C-1M, C-1 W and K-1 M Final C-1M, C-1 W and K-1 M Medals ceremony Trials SLALOM CROSS K1M and K1W
Sunday, 12th	9:30 - 11:15 h 12:00 - 13:00 h 13:05 h 15:30 - 17:20 h 17:25 h 19:00 h	Semi-final K-1 W and C-2 M Final K-1 W and C-2 M Medals ceremony Slalom Cross 1/8 Final, ¼ Final, Semi-final and Final Medals ceremony Snack for teams, judges, volunteers and organization

White Water Slalom cross: a new official competition

Why a new slalom cross format is developed?

- To welcome new athletes from other canoeing disciplines
- To provide a more accessible competition format
- To open more competition sessions on the Olympic venue
- To present a TV oriented and spectators' friendly competition
(Easy to follow, spectacular, unpredictable or at least with a spectacular suspense)
- This format has to be easy to develop, easy to organise for National Federations.

Which framework?

- Head to head, 4 boats competing together a maximum for the final phase
- Kayak boat only, one female and one male event
- Same boat for all at the competition (plastic from recreational market)
- Spectacular start line but fair, ramp when possible
- Course marked with special gates (or obstacles), it imposes a spectacular trajectory with options but using extreme white water features of the particular course
- Two symmetric upstream gates on same line or close (athletes chose which one they negotiate)
- Eskimo roll zone
- Time duration around 45 seconds long
- No timing of the head to head series. It is possible that individual time trials are organised to qualify the start field of the head to head phase and built the bracket
- No penalty touch, elimination for for gate (obstacle) missed

Milestones for implementation

Prepare a specific set of ICF rule articles for this event to be presented to the Board for vote at the 2016 Congress and implementation in 2017 and having the first and official 2017 ICF kayak slalom cross World Championships organized in Pau



Entries and Important dates to remember for Team Leaders



Numerical and Nominal entries:

Entries will be done on the form designed and provided by the ICF, which will be available on-line on: ICF integrated sport data platform (SDP) <https://icf.msl.es/icf/icf.jsp>

Numerical entries: before 26th April

Nominal entries: before 27th May

For further information relating to the SDP process: <http://www.canoeicf.com/online-entries> or <http://www.canoeicf.com/reminder-online-entries>

All entries sent after 27th May will have to be accepted by the Chairman of the ICF Canoe Slalom Committee (ICF rules - art. 11.2)

Please, remember:

Respect of the deadlines

Quality of the biography information and picture provided for athletes and team staff members

Information number boats x nation:

http://www.canoeicf.com/sites/default/files/2016_icf_csl_world_cup_quota_information.pdf

KEY DATES:

April 26th	Last day for numerical entries by ICF online system
May 27th	Last day for NOMINAL ENTRIES and ACCREDITATION by ICF on line system
June 6 th	Opening free official period training
June 8 th	Team Leaders Meeting
June 9 th	Opening Ceremony

Accreditation and participation fee

ICF ON-LINE ACCREDITATION SYSTEM: <https://icf.msl.es/icf/icf.jsp>

This system will allow National Federation delegation members and Officials to register online and get the accreditation at their arrival on site.

If you are in need of a User ID and Password or have a suggestion or a problem, please contact Michael Noyelle to: isis@canoeicf.com

PARTICIPATION FEE FOR ALL THE MEMBERS OF THE TEAMS:

Price of each accreditation for all days: **105 Euros**

It Includes:

- Training in the course during official period
- Automatic Chrono and video service in the competition days
- Drinks and fruits in the competition days
- Snack in the closing party

NATIONAL FEDERATION (NF) categories: 27th May dead line for reception

Qualification	Symbol	Remarks	Cost
Athletes	Aa	Limited to registered athletes on ICF online entries	105 €
Team Leader	Ac	2 accreditations max. per nation	105 €
Technical staff	Ao	-	105 €
Medical Staff	Am	-	105 €
National Federations guests	NF-VIP*	Gives access to the VIP area	105 €
President or Secretary General of NF	NF-VIP	2 per nation To be validated by ICF	Free
International Officials	ICF ITO	According to the list edited by the ICF	Free

HOW TO PAY PARTICIPATION FEE?

The payment can be made by bank transfer or on site at your arrival at La Seu d'Urgell.

Bank Transfer needed details:

IBAN: ES49 2100 3603 7022 0026 1988

SWIFT Code: CAIXESBBXXX

Banc account name: PARC DEL SEGRE SA
c/ Circumval.lació s/n 25700 La Seu d'Urgell - Spain

Accommodation, entries, press, media and VISA information



ACCOMMODATION

Please, see this web site <http://www.turismeseu.com>, where you can find all the options (hotels, rural accommodations, etc...)

For more information or booking you can call Tel. (34) 973 35 15 11 or send an e-mail: reserves@turismeseu.com

PRESS AND MEDIA INFORMATION

Information will be available at <http://canoeslalomseu.parcolimpic.cat> in the section "Press"

There will be live coverage by TVE for all competition: heats, semi-final and final

BOAT STORAGE

Boat storage will be placed near flat water in Parc Olímpic del Segre

INTERNET ACCESS

Free wireless internet access will be available at Parc Olímpic del Segre

ACCESS PARC AND PARKING

Free access pass and car parking near Parc Olímpic del Segre will be guaranteed.

VISA

The Royal Spanish Federation of Canoeing is pleased to inform:

If you need a visa, please as soon as possible send us this details by e-mail to: correo@rfep.es

Name	Family Name	Date of birth	Passport number	Expiry date	Sex	Status	Nationality

Information from the organizer

TRANSPORTATION

The Organizing committee will provide with transportation from and to Barcelona airport for all members of the ICF Jury.

Also Organizing Committee can organize transportation from and to Barcelona airport for the teams, their members and all ICF officials.

If you are interested, please as soon as possible contact by e-mail: canoeslalomseu@parcolimpic.cat

MEDICAL SERVICES IN LA SEU D'URGELL

The health care services of the Sant Hospital Foundation will be available for canoeists and accompanying personnel.

This Hospital has beds, orthopaedic and surgical departments and emergency services including treatment at accommodation.

The official training days and competitions days (according to the programme) in Parc Olímpic del Segre will be covered by first aid and ambulance service for transportation to hospital if necessary.

WEATHER IN LA SEU D'URGELL

The weather is gentle and the climate is Mediterranean.

In June, the temperatures are warm at day and cool at night with sunny days. The average daily temperature is 20° C, and average rainfall is 67mm/month.

During the competition hours, the maximum temperature is around 25 °C



Contacts



CONTACTS:

Real Federación Española de Piragüismo <http://www.rfep.es>

c/ Antracita, 7 -3º

28045 MADRID

Tel (34) 91 112 38 05

Fax (34) 91 530 58 25

E-mail: correo@rfep.es

Parc Olímpic del Segre <http://canoeslalomseu.parcolimpic.cat>

25700 La Seu d'Urgell (Lleida)

Tel. 34 973 36 00 92

Fax. 34 973 36 01 92

E-mail: canoeslalomseu@parcolimpic.cat

Internacional Canoe Federation <http://www.canoeicf.com>

La Seu d'Urgell Tourist information <http://www.turismeseu.com>

La Seu d'Urgell Town hall <http://www.laseu.cat>

Catalan Canoeing Federation <http://www.fcpiraguisme.com>



Ajuntament de
La Seu d'Urgell



los 16
de BRASIL 2016

Parc Olímpic del Segre - 25700 La Seu d'Urgell (Lleida) Tel. (34) 973 36 00 92 Fax. (34) 973 36 01 92
<http://canoeslalomseu.parcolimpic.cat> - E-mail: canoeslalomseu@parcolimpic.cat

Real Federación Española de Piragüismo - c/ Antracita, 7 -3º - 28045 MADRID
Tel. (34) 911123805 - <http://www.rfep.es> - E-mail: correorfep@rfep.es