

2025 ICF Canoe Slalom World Cup Prague, Czechia

Team Leaders Guide

Contents

1. Introduction	1
2. Competition officials.....	1
3. Canoe Slalom Rules and Rules Appendices	1
4. Official communication channels	2
a. ICF Canoe Slalom events communication channels	2
b. 2025 ICF CSL World Cup 3 Prague official communication channel	2
5. Pre-race requirements (checklist)	2
a. Anti-doping education program.....	2
b. Entry list checking.....	2
c. Official training sessions requests	3
d. Guidelines for advertising on equipment.....	3
i. Generic guidelines	3
ii. !! Specific guidelines for 2025 ICF CSL World Cup 3 Prague	3
e. Athlete's headshot	4
f. Technical Video Service.....	4
6. Venue information	4
a. !! Course information.....	4
b. !! Venue layout	4
c. !! NF areas	5
d. !! Green box studio	5
e. !! Equipment control	5
f. !! Doping control.....	6
g. !! Enquiry/Protest desk	6
h. !! Medal ceremonies	6
7. Competition information.....	6
a. !! Official training schedule.....	6
b. !! Competition schedule.....	6

c.	Demonstration runs	6
i.	!! Demonstrators / Forerunners	6
ii.	!! Prague Slalom GP – Thursday 26.06.25	7
iii.	!! World Cup – Friday 27.06.2025	7
d.	!! Course map distribution	7
e.	Course approval	7
i.	Generic rules.....	7
ii.	!! 2025 ICF CSL World Cup 3 Prague course approval information	7
f.	!! Bib distribution	8
g.	!! Team Leaders reception	8
8.	Canoe & Kayak events	8
a.	!! Pre-start procedure.....	8
b.	Start.....	8
i.	Generic rules.....	8
ii.	Specific rules	9
➤	!! Prague Slalom GP	9
➤	!! World Cup: Canoe and Kayak events.....	9
c.	Finish	10
i.	Generic rules.....	10
ii.	!! Specific rules	10
9.	Kayak Cross events	10
a.	Pre-start procedure.....	10
i.	Generic rules.....	10
ii.	!! Specific rules	10
b.	Start procedure	11
i.	Generic rules.....	11
➤	Elimination phases	11
ii.	!! Specific rules	11
➤	!! Kayak Cross Individual	11
c.	Finish	11
i.	Generic rules.....	11
ii.	!! Specific rules	12
d.	Rules reminder	12
10.	ICF topics	12
a.	Athletes' commission	12
b.	Sport Equipment Survey.....	12

c.	2025 ICF World Championship Penrith	12
11.	Appendices	13
a.	!! Appendix 1 - Venue Map	1
b.	!! Appendix 2 – Demonstrators / Forerunners	0
i.	Shorter format	0
➤	Demonstration	0
➤	Forerunners	0
ii.	Canoe and Kayak events	0
➤	Demonstration	0
➤	Forerunners	0
iii.	Kayak Cross events	1
➤	Rehearsal (2 races)	1
➤	Kayak Cross Individual – Forerunners	1
➤	Kayak Cross– Forerunners	1
c.	!! Appendix 3 – Bib design allocation	2
i.	Forerunners	2
ii.	CSL Individual events (including shorter format)	2
iii.	Kayak Cross Individual	2
iv.	Kayak Cross elimination phase	3
d.	!! Appendix 4 – Reception at Mayor’s residence	4

1. Introduction

The ICF is delighted to welcome you for this 2025 canoe slalom World Cup season.

In this Team Leader Guide, you will be able to find generic information that apply for the whole season. In addition, as soon as the World Cup organizer and ICF have settled all the details regarding this specific competition, an updated Team Leader Guide will be sent with all the generic and specific information.

If you have any questions, ICF topics or specific to the event, please contact the person in charge, referred in the following tab:

Role	Name	Contact details
CSL Committee Chair	Richard Fox	richard.fox@canoeicf.sport
CSL Committee members Event managers	Sue Natoli	sue.natoli@canoeicf.sport
	Alena Maskova	alena.maskova@canoeicf.sport
ICF staff Event Whitewater managers	Thomas Rosset	thomas.rosset@canoeicf.sport
	Manon Bocquet	manon.bocquet@canoeicf.sport
Competition Manager	Jiří Rohan	rohan@slalomtroja.cz

2. Competition officials

Role	Name
Jury Chair	Inaki GOMEZ (SLO)
Jury Member	Jaroslav POLLERT (CZE)
Jury Member	Cristian TOBIO REYERO (AND)
Competition Manager	Jiří ROHAN (HOC)
Chief Official	Sue NATOLI (ICF)
Chief Judge	Meritxell RODRÍGUEZ (ICF)
Technical Organiser	Pavel PŘINDIŠ (HOC)
Course designer nominated by the ICF	Davide MONGUZZI (ICF)
Course designer nominated by the ICF	Marcel POTOČNÝ (HOC)

3. Canoe Slalom Rules and Rules Appendices

This competition will be run under the [ICF Canoe Slalom Rules](#) and [Appendices](#) and according to the specific information listed in this Team Leader Guide.

Any decision which could be voted during the Team Leader Meeting will be updated in the Team Leader Guide before the start of the competition.

4. Official communication channels

a. ICF Canoe Slalom events communication channels

Whatsapp group: [official link](#)



b. 2025 ICF CSL World Cup 3 Prague official communication channel



5. Pre-race requirements (checklist)

a. Anti-doping education program

All athletes, coaches, and support personnel must have completed the relevant anti-doping online course on the WADA Anti-Doping Education Learning platform (ADEL) corresponding to their role. The certificates showing completion should be sent by each National Federation to sue.natoli@canoeicf.sport. Previous certificates are still valid for this season. There is no need to repeat the program unless the person's role changes (e.g. athlete becoming coach).

Accreditations will not be issued until the certificates are marked off.

More information on [ICF website](#)

[Link](#) to access ADEL program

b. Entry list checking

Once the team leader arrives on the competition site, they must go to the accreditation office to check:

- the entry list per nation and notify any modifications
- the national anthem
- the national flag

c. Official training sessions requests

If any NF has a specific request concerning the official training sessions for a competition, these ones must be sent by email to the technical managers: [Thomas Rosset](#) and [Manon Bocquet](#) before the nominal entries' deadline (10 days minimum prior to the event). No requests will be considered after that deadline.

The ICF team will try to answer at their best to those requests when building the official training schedule. Do not consider that a request sent is officially stated.

d. Guidelines for advertising on equipment

i. Generic guidelines

For canoe slalom boats, ICF Nation and athlete's name stickers are mandatory. Further information can be found in the [ICF guidelines for advertising trademark identification on equipment](#) document.

For Kayak Cross boats, only the Nation Sticker will be required. It has to be placed freely in a suitable place in front of the cockpit. The actual location may vary depending on the model of the boat. The Nation sticker is the same dimensions as for the Canoe Slalom boats.

ii. Specific guidelines for 2025 ICF CSL World Cup 3 Prague

The HOC will provide an event sponsor logo sticker, which must be placed below the NOC sticker. Stickers will be distributed together with the bibs.



e. Athlete's headshot

The ICF TV will shoot a video (8s without sound) of athletes for sport presentation. Athletes, who have not yet had a video taken, (they have been advised of this directly) should attend this short shooting session (maximum 2 minutes) in dry competition gear. Any other athletes are welcome to update their video if they wish when the studio is open and not too busy.

For the first event of the season, a specific planning will be shared and organized over the official training schedule.

f. Technical Video Service

A TVS feed download solution will be available for all events and demonstration runs.

a) Wired solution

At the beginning of the 2025 season, to access the TVS feed each team must attend a "testing" meeting **in the NF area at 12:45 on Thursday 26.06.2025** and register on the [2025 Canoe Slalom TVS management form](#). Teams who do not attend this meeting will not have access to the TVS feed.

The purpose of this meeting is to make sure that the system will work under full load and to troubleshoot any issues teams have. **Hans Peter WEISS** will be available at this time to assist the teams.

- Each NF will have access to the wired solution in their tent
- To connect correctly please follow the [TVS step by step documentation](#)

b) Cloud solution

During the season a cloud solution will be implemented. Once validated and fully operational, the TVS fees will be accessible for all the NF remotely.

For any question or assistance regarding TVS, please contact: tvsl@canoeicf.com.

6. Venue information

a. !! Course information

Name of the course	White Water Centre Prague Troja
Competition course length	250 m
Competition course drop	3,5 m
Competition course flow	14 m ³ /s
Water regulation on course	Inlet gate

b. !! Venue layout

A venue map is attached in Appendix 1.

c. **!! NF areas**

- The NF area is in the garden, with the entrance on the left side of the road near the start.
- Extra tents may be installed in the NF area close to the NF tents.
- **NF parking** is located on the grass area above the Boathouse. Parking is only permitted with a valid parking card, which will be distributed through the Sport Info Office.
- **Free lunches** will be provided for all accredited athletes and team staff on competition days, with accreditation required. **Lunch times** are Friday from 11:00 to 14:00, and Saturday and Sunday from 11:30 to 14:00. Additionally, **snacks** will be available throughout the day in the Athletes' Lounge in the NF area.

Power distribution

- Please make sure that your electrical equipment is reliable and do not create any shortcuts or overload on the main NF area network during the competition.

Wireless routers

Wireless routers may be used if they are NOT within the following frequency:

- 5785 GHz, band width +/- 20 MHz
- 5825 GHz, band width +/- 20 MHz
- At no time should any wireless router system be connected to the computer which is connected to the TVS LAN cable
- All devices, including any wireless routers, must be named with National Federation code and device number e.g. AUS1, AUS2, AUS3 – unnamed devices will be removed from the system.
- Any team found to be using a device affecting the competition will have power removed to their compete system.

d. **!! Green box studio**

- Location: **TV room at the bottom of the course (Koala Sport Shop)**
- Timing: **open on Wednesday 25/06/2025 from 09:00 – 17:00**
- Athletes must wear their dry competition gear.
- A dedicated schedule and guidelines will be shared on the Team Info Webpage.

e. **!! Equipment control**

- Equipment Control is located **at the end of the course**. Athletes have to exit via the steps and go through the equipment control area.
- Self-checking is open: **Thursday 26th June from 9.00 to 16.00**.
- Equipment control will be open each competition day 1h before the 1st boat starts.
- Hiko buoyancy vest: Athletes with worn labels on the Hiko buoyancy vest can take them to the Hiko Shop at the venue to discuss resolution. As long as the buoyancy

vest is the good condition and on the list, athletes won't be penalised for a worn label.

- In Canoe and Kayak event and in Kayak Cross Individual: post competition control and random checking.
- In Kayak Cross, during elimination phases: pre-competition.

f. !! Doping control

- Location: **next to the accreditation, behind the gym.**
- Athletes will be notified for Doping Control in the finish area.
- Passports or ID are required for Athletes selected for doping control.

g. !! Enquiry/Protest desk

- Location: **in front of the OVR.**

h. !! Medal ceremonies

- Location: **the grass area at the middle of the course, see map in Appendix 1.**
- Schedule: see competition schedule, after each session of final.
- Uniform drop out: **tent behind the podium.**
- Athletes involved in the Finals for both Canoe Slalom and Kayak events should bring their national uniform to the medal ceremony preparation area. There will be boxes there to place the uniform in. There is only a short time between the end of the competition and the medal ceremonies.
- Athletes involved in the Finals of Kayak Cross Individual and Kayak Cross events will wear their **competition gear** on the podium.

7. Competition information

All the information concerning the competition are available and updated online on the dedicated ICF event Team Info webpage: [2025 ICF CSL World Cup 3 Prague](#)

a. !! Official training schedule

- Canoe slalom and kayak cross training session starts on Monday till Thursday.
- Exact timings and updates are available on the online [official training schedule](#).

b. !! Competition schedule

- The course is closed following the end of official training (**Thursday 26.06.2025 at 17:00**) until the end of the competition.
- The competition schedule version 3 will be posted on the dedicated [ICF event Team Info webpage](#) on **Thursday 26.06.2025 by 10am** and spread on the WhatsApp Group.

c. Demonstration runs

i. !! Demonstrators / Forerunners

The list of forerunners is available in Appendix 2.

ii. **!! Prague Slalom GP – Thursday 26.06.25**

PRAGUE SLALOM GP CONSTRUCTION					
15:30:00	16:30:00	CSL - Course preparation			01:00:00
16:30:00	17:40:00	CSL - Course construction			01:10:00
17:40:00	18:25:00	CSL - Course Tuning			00:45:00
18:25:00	18:30:00	Course review with technical manager			00:05:00
18:30:00	18:35:00	Course approval			00:05:00
		Interval			00:10:00
18:45:00	19:01:00	Full length demo run rehearsal	8	00:02:00	00:16:00

iii. **!! World Cup – Friday 27.06.2025**

CSL COURSE CONSTRUCTION					
16:10:00	17:25:00	CSL - Course construction			01:15:00
17:25:00	18:10:00	CSL - Course Tuning			00:45:00
18:10:00	18:15:00	Course review with technical manager			00:05:00
18:15:00	18:20:00	Course approval			00:05:00
		Interval			00:10:00
18:30:00	18:46:00	Full length demo run rehearsal	8	00:02:00	00:16:00

d. **!! Course map distribution**

The Kayak Cross course map will be available on **Monday 23.06.2025** on the dedicated ICF event Team Info webpage.

The canoe slalom course maps (Prague GP and World Cup) will be posted on **Thursday 26.06.2025 by 17:00** on the dedicated ICF event Team Info webpage and spread on the WhatsApp Group.

e. **Course approval**

i. **Generic rules**

The ICF wants to remind you that the course designers are:

- Selected from a pool of people skilled enough and proposed by the NF,
- Are ITOs, which means independent from any NF during the competition.

Any pressure or kind of harassment towards the course designers, as for any ITOs, may lead to sanctions.

ii. **!! 2025 ICF CSL World Cup 3 Prague course approval information**

National federations feedback about the course designs can be reported to the ICF Technical manager, to be integrated into the Course Approval process.

ICF technical manager in charge: **Manon Bocquet**

Feedback will be accepted from only one representant per federation at the following times:

- Slalom GP: on **Thursday from 18:25 to 18:30 at the lower bridge (river right)**
- World Cup: on **Friday from 18:10 to 18:15 at the lower bridge (river right)**

f. !! Bib distribution

The full list of the bibs per event is available at Appendix 3.

- Training bibs will be available from the Accreditation Centre from Monday (23.06.25) morning.
- CSL Competition bibs will be same for Friday (Prague Slalom GP) and Saturday (World Cup) and will be available from the Sport Info Office from 12:00 on Thursday 26th June. All training bibs have to be given back at the same time.
- The accreditation fee must be fully paid to receive competition bibs.
- CSL Competition bibs must be returned to the Sport Information Office following the competition. There will be a deposit 50 €.
- For Kayak Cross Individual, bibs will be available from the Sport Info Office from 12:00 on Thursday 26th June.
- For Elimination phases the numbered and coloured bibs will be distributed individually at the start area.

g. !! Team Leaders reception

It is our pleasure to invite you to a reception held under the auspices of the Mayor of Prague. The reception will take place on Wednesday, 25 June at 8:00 PM at the Mayor's Residence, Mariánské náměstí 1, Prague 1.

If you are arriving by car, we recommend using the underground parking at Jana Palacha Square (GPS: 50°5'23"N, 14°24'53"E).

See the map in Appendix 4.

8. Canoe & Kayak events

a. !! Pre-start procedure

- There will be a clock, facing into the warm-up area showing race time and the next athletes to start.
- For Short Slalom, this clock will only show the race time.

b. Start

i. Generic rules

- At all times, the athletes must follow the Starter's instruction, or they may be disqualified for the run.
- At the start, there will be a countdown clock showing the time to start.
- Athletes may move to the start position once the previous Athlete has broken the beam but must be at the start position 15 seconds before their start.
- There will be an acoustic signal (10 seconds before start, and then from 5 seconds before start - 4 shorts, 1 long - start).
- Athletes may start 5 seconds either side of their official start time which is signified by the long beep on the start clock.

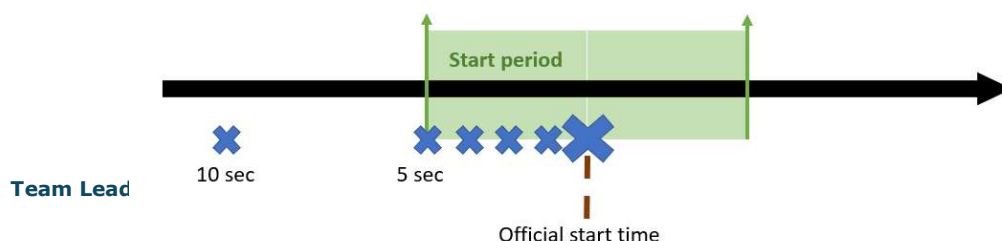

ii. Specific rules

➤ **!! Prague Slalom GP**

- The start will be located in the big eddy, as shown on the course map. The start position will be downstream, between two rapid blocks placed high in the eddy. Athletes will need to enter from below, entry through the backdrop will not be possible.
- The beam line will be set far enough downstream to avoid being broken as athlete enter.

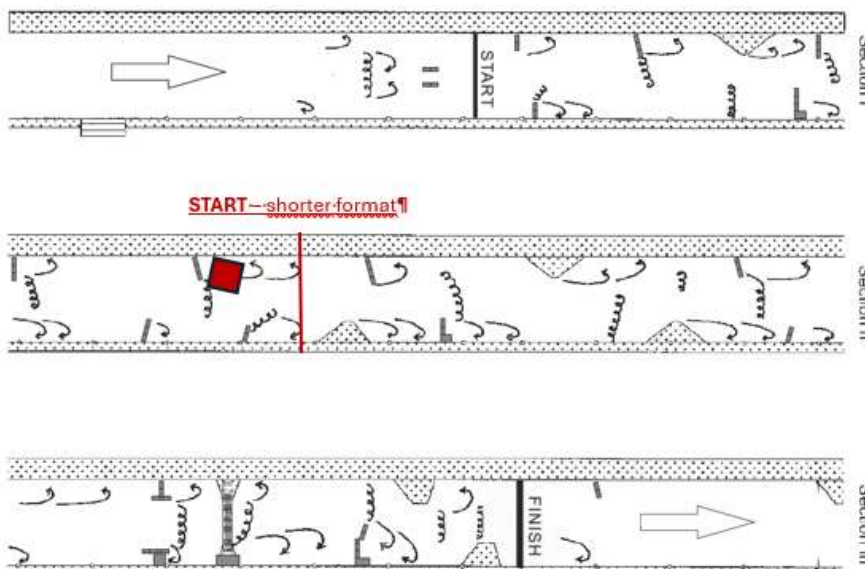

➤ **!! World Cup: Canoe and Kayak events**

- The start is below the Kayak Cross start ramp between the Rapid blocks.
- The beam line is 5 m below the starting position.



c. Finish

i. Generic rules

- During the finals, the leading, the second and third athlete must proceed to the "Kiss and Cry" area located after equipment control where TV will interview them.
- Athletes must not leave the finish zone until dismissed by the Equipment Control Official once they are no longer needed for the ceremonies, anti-doping or equipment control.
- They then proceed via the mixed zone back to the Athlete area.
- Athletes should wear their competition bib in the mixed zone for identification purposes.

ii. **!! Specific rules**

- The finish beam is located **20 m above the last concrete point.**
- The finish beam is marked **by two yellow finish buoys.**
- All Athletes must exit via **the steps at the end of the course and pass through equipment control and mixed zone.**
- During the finals, the three first athletes must proceed to **the Kiss and Cry area located on the water, river left after the finish line.**



9. Kayak Cross events

a. Pre-start procedure

i. Generic rules

- Athletes need to be at the pre-start area prior to their start to prepare their boats (and equipment control during the Elimination phase), and receive any final instructions (coloured bibs distribution, choosing their start lane).
- Volunteers will be there to help your Athlete if needed on the ramp.

ii. **!! Specific rules**

- Access to start ramp is **from the right bank.**

b. Start procedure

i. Generic rules

- An automatic start machine will be used for all phases.
- At all times the athletes should follow the starters instructions.
- The start time for Kayak Cross Individual will be triggered by photocell.
- At the start, a Pre-Start Official will inform your Athlete if they have progressed.
- The start position is with both hands on the paddle and along the side of the kayak. The paddle must be parallel to the plane of the platform. The front hand has to be placed over middle of the boat on one side and touching the boat or the spraydeck



- The start orders will be the following ones:
 - 1) "In position" => the athletes must place their paddle in the start position
 - 2) "Ready" => the athletes wait in steady position; no movement is allowed following the "Ready" command
 - 3) The platform will tilt to indicate the start. The starter will not say "Go".

➤ **Elimination phases**

- Athletes should be settled in the start position on the ramp 90 seconds before their start time. There will be volunteers to assist them if needed.

ii. **!! Specific rules**

➤ **!! Kayak Cross Individual**

- Athletes must start from **lane 2** on the platform (**second lane from river right**)
- The start interval is **60 seconds**; athletes should get in their boat behind the platform. They will then be assisted to move to the starting lane.
- The start time for Kayak Cross Individual will be triggered automatically by **the start gate**.

c. Finish

i. Generic rules

- The finish time for Kayak Cross Individual will be triggered by photocell.
- During the Elimination phase a photo finish system will be deployed.

ii. Specific rules

- The Finish line will be the same as for CSL.

d. Rules reminder

o Kayak Roll

To be correctly performed in Kayak Cross competition, a kayak roll must meet the following criteria:

- the roll must be 360 degrees
- at some point under the barrier the boat needs to be rolled 180 degrees

10. ICF topics

a. Athletes' commission

Athletes' commission chair: Bridgitte HARTLEY (RSA)

Are you interested in helping to share the future of your sport and represent the interests of your fellow athletes?

- Contact: Inform your National Federation to submit your nomination
- Deadline: July 14
- Voting: Athletes will cast their votes during the World Championships in Penrith
- Election: Two Slalom athletes (1 male and 1 female)
- Terms in Office: 2025-2029

b. Sport Equipment Survey

Please fill and share with your athletes the "Sport Equipment Survey"



c. 2025 ICF World Championship Penrith

Please register to the numerical entries for the 2025 ICF World Championships in Penrith.

- o Numerical entries – please complete
- o Boat transportation
 - Via air with Destination Travel, see @Jill.Bassett@Paddle.org.au
 - Via Sea with Prowave, contact

11. Appendices

Appendix 1 – Venue Map

Appendix 2 – Demonstrators / Forerunners

- Shorter format
- Canoe & Kayak events
- Kayak Cross

Appendix 3 – Bibs design allocation

- Forerunners
- CSL Individual events
- Kayak Cross Individual
- Kayak Cross elimination Phases

Appendix 4 – Reception map



a. !! Appendix 1 - Venue Map



ICF CANOE SLALOM WORLD CUP PRAGUE CZECH REPUBLIC

27.6.- 29.6. 2025

VENUE

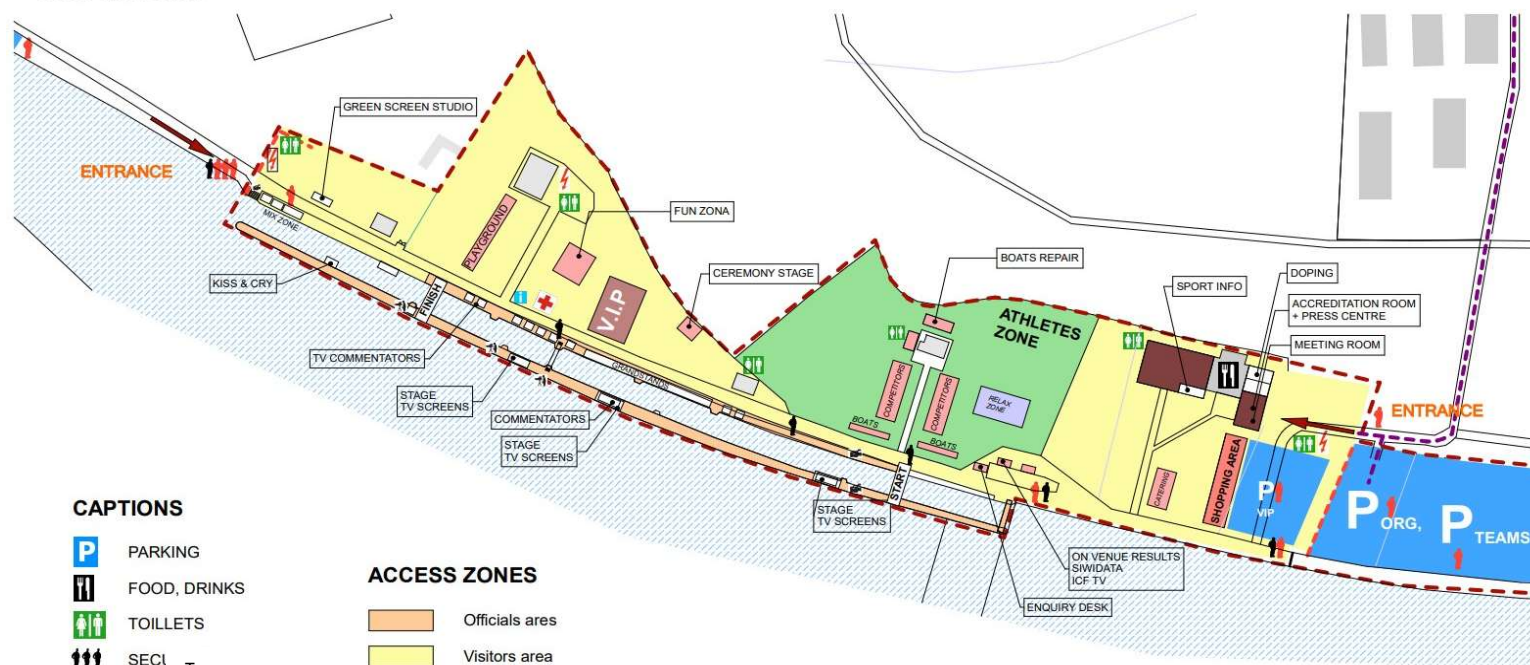

CAPTIONS

- PARKING
- FOOD, DRINKS
- TOILETS
- SECURITY
- ORGANIZERS
- MEDICAL SERVICE
- TWO CIRCLES
- ELECTRICITY

ACCESS ZONES

- Officials area
- Visitors area
- Teams quarters and areas
- Media areas
- Back of house
- VIP areas

--- AREA BORDER

--- ARRIVAL FOR ORGANIZERS, TEAMS AND V.I.P. ONLY

Team Leader Guide - 2025 CSL World Cup Prague

b. **!! Appendix 2 – Demonstrators / Forerunners**

i. **Shorter format**

➤ **Demonstration**

- Course tuning
- Full course rehearsal

Bib	Event	Name	Bib	Event	Name
F1	WK1	Hilgertová Amálie	F5	WK1	Galušková Bára
F2	MK1	Semerád Adam	F6	MK1	Panzer Martin
F3	WC1	Říhová Eva	F7	WC1	Erlová Natálie
F4	MC1	Kratochvíl Lukáš	F8	MC1	Větrovský Tomáš

➤ **Forerunners**

- Full course forerunners

Bib	Event	Name	Bib	Event	Name
F1	WK1	Hilgertová Amálie	F5	WK1	Galušková Bára
F2	MK1	Semerád Adam	F6	MK1	Kopeček Michal
F3	WC1	Říhová Eva	F7	WC1	Erlová Natálie
F4	MC1	Kratochvíl Lukáš	F8	MC1	Větrovský Tomáš

ii. **Canoe and Kayak events**

➤ **Demonstration**

- Course tuning
- Full course rehearsal

Bib	Event	Name	Bib	Event	Name
F1	WK1	Hilgertová Amálie	F5	WK1	Mrázková Klára
F2	MK1	Panzer Martin	F6	MK1	Kopeček Michal
F3	WC1	Říhová Eva	F7	WC1	Erlová Natálie
F4	MC1	Chaloupka Václav	F8	MC1	Rohan Lukáš

➤ **Forerunners**

- Full course rehearsal

Bib	Event	Name	Bib	Event	Name
F1	WK1	Hilgertová Amálie	F5	WK1	Mrázková Klára
F2	MK1	Semerád Adam	F6	MK1	Kopeček Michal
F3	WC1	Říhová Eva	F7	WC1	Erlová Natálie
F4	MC1	Chaloupka Václav	F8	MC1	Kratochvíl Lukáš

iii. Kayak Cross events

➤ Rehearsal (2 races)

- 2 races, two sets of 4 athletes (men, women)
- Full course rehearsal

Bib	Name	Name
Red	Panzer Martin	Hilgertová Amálie
Green	Kopeček Michal	Mrázková Klára
Blue	Kratochvíl Lukáš	Galušková Bára
Yellow	Rohan Lukáš	Beková Kateřina

➤ Kayak Cross Individual – Forerunners

- Full course rehearsal

Bib	Name
F1	Panzer Martin
F2	Rohan Lukáš
F3	Hilgertová Amálie
F4	Mrázková Klára

➤ Kayak Cross– Forerunners

- Full course rehearsal

Bib	Name
Red	Kopeček Michal
Green	Kratochvíl Lukáš
Blue	Hilgertová Amálie
Yellow	Mrázková Klára

c. **!! Appendix 3 – Bib design allocation**

Deposit 50 €

i. **Forerunners**

Red bibs with black F1 – F8

ii. **CSL Individual events (including shorter format)**

All athletes have the same bib for both slalom events – shorter (Friday) and classic (Saturday).

WK1 – red	WC1 – purple	MK1 – blue	MC1 – black

iii. **Kayak Cross Individual**

Kayak Cross Individual bibs will be collected at the finish line and redistributed at the pre-start area for the elimination phase.

WOMEN – red	MEN – blue

iv. Kayak Cross elimination phase

Kayak Cross Individual bibs will be collected at the finish line and redistributed at the pre-start area for the elimination phase.

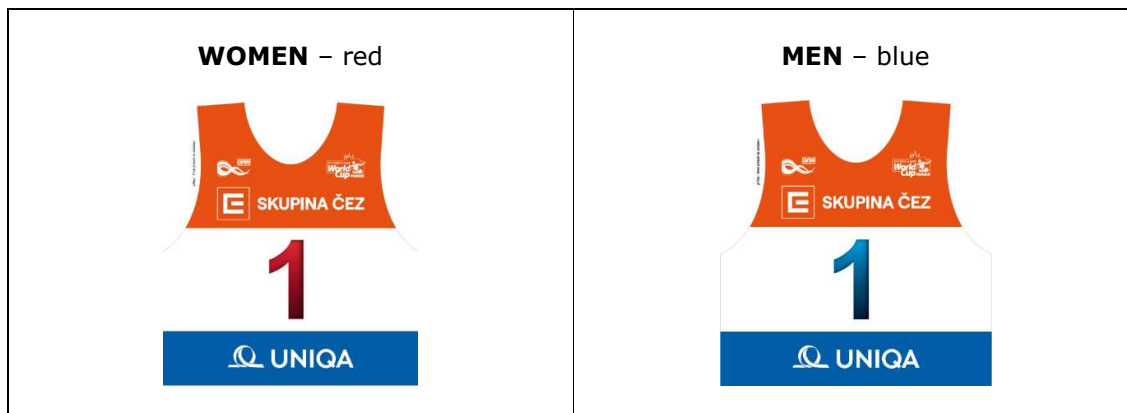

d. !! Appendix 4 – Reception at Mayor's residence

ICF CANOE SLALOM WORLD CUP
PRAGUE CZECH REPUBLIC
27.6. - 29.6. 2025

BANQUET FOR TEAM LEADERS, ICF, V.I.P.
25.6.2025, 8:00 PM



NÁRODNÍ
SPORTOVNÍ
AGENTURA

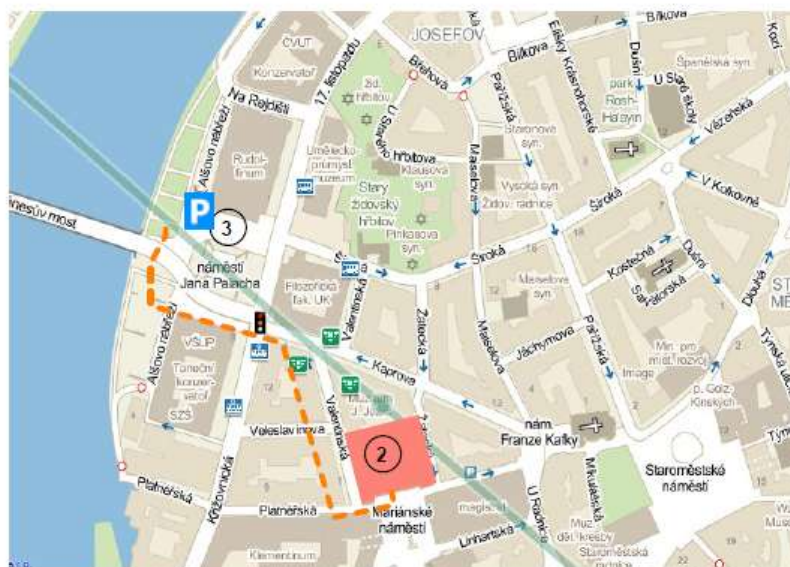

CAPTIONS

— BY CAR

— WALK

① VENUE

② MUNICIPAL LIBRARY

③ UNDERGROUND
PARKING
"JANA PALACHA SQUARE"

Underground Parking:
"Jana Palacha Square"

GPS: 50°5'23"N, 14°24'53"E

Banquet:
Městská knihovna,
Mariánské náměstí 1/98, Praha 1

GPS: 50°5'15"N, 14°25'2"E